

# AI Fantasy Zoo

## **Overlord of the Earth Dinosaur Model Building Manual**

# Warning



## 3PIN cable:



Can only be inserted into port 1, 2, 3, 4, 5;



Do not insert other ports.

## 2PIN cable::



Can only be inserted into port 7;



Do not insert other ports.

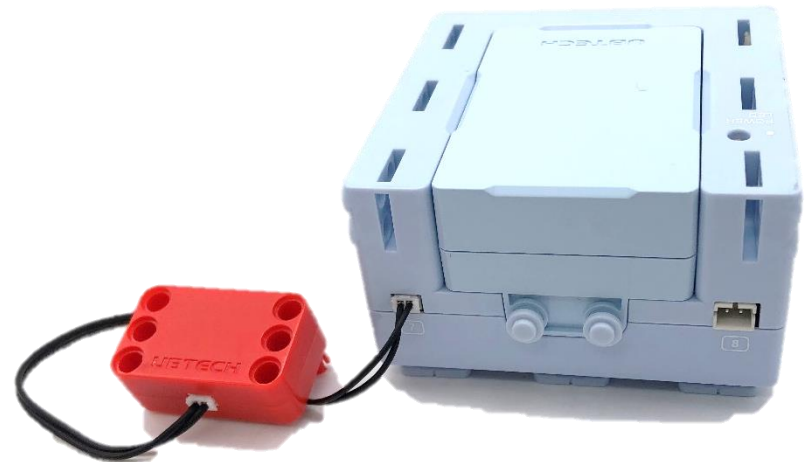

# Overall effect diagram

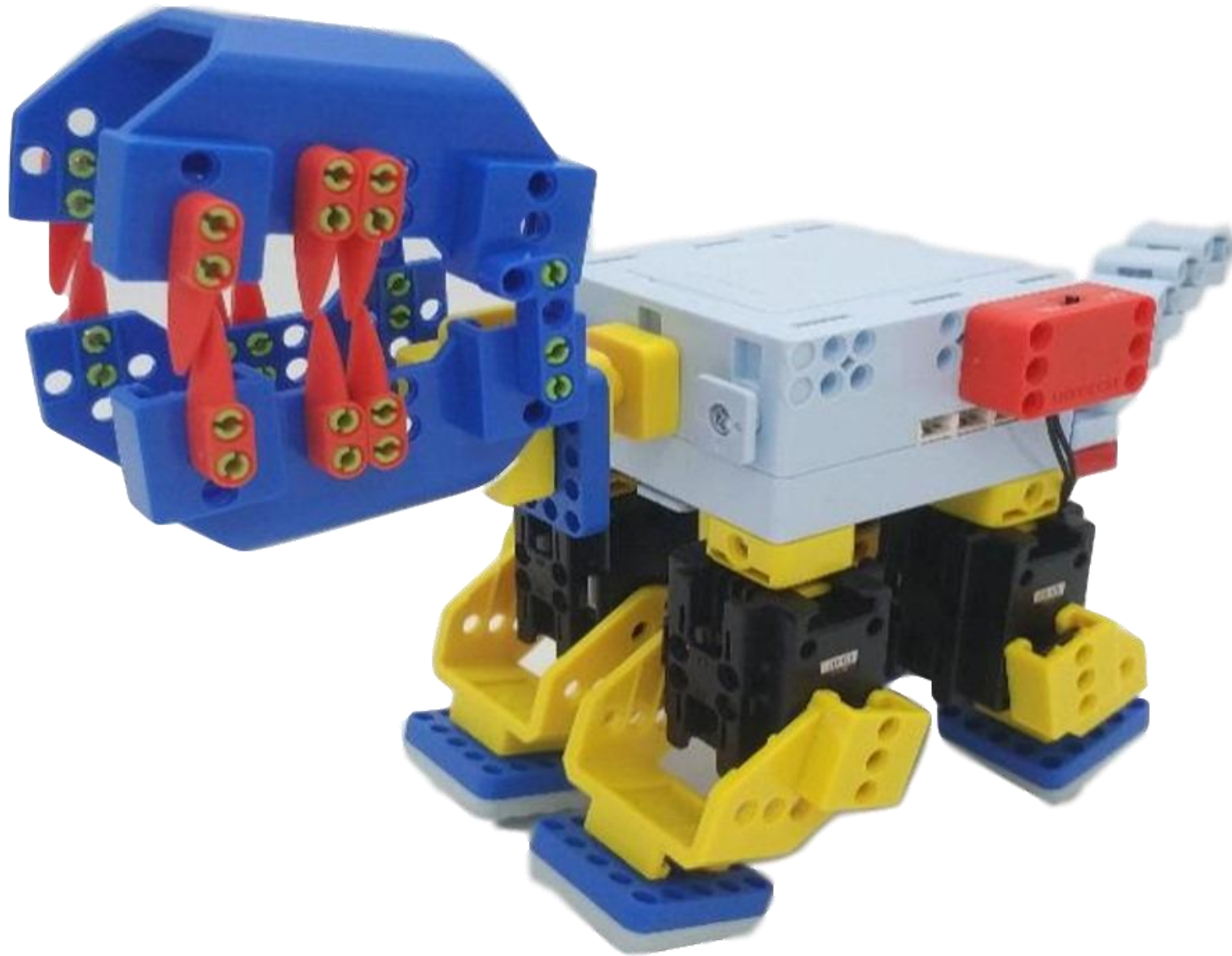

# Materials preparation

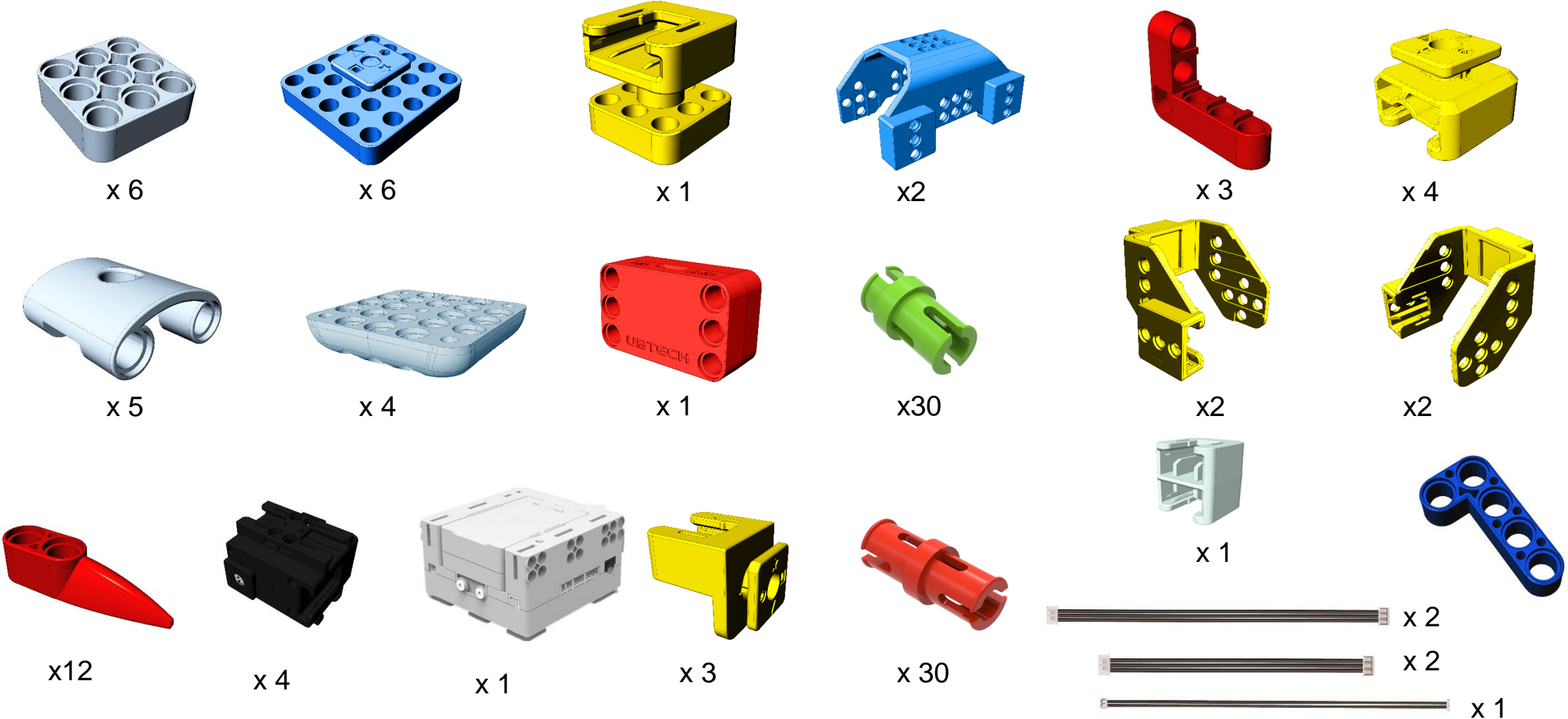

The model consists of 3 parts, as shown below:

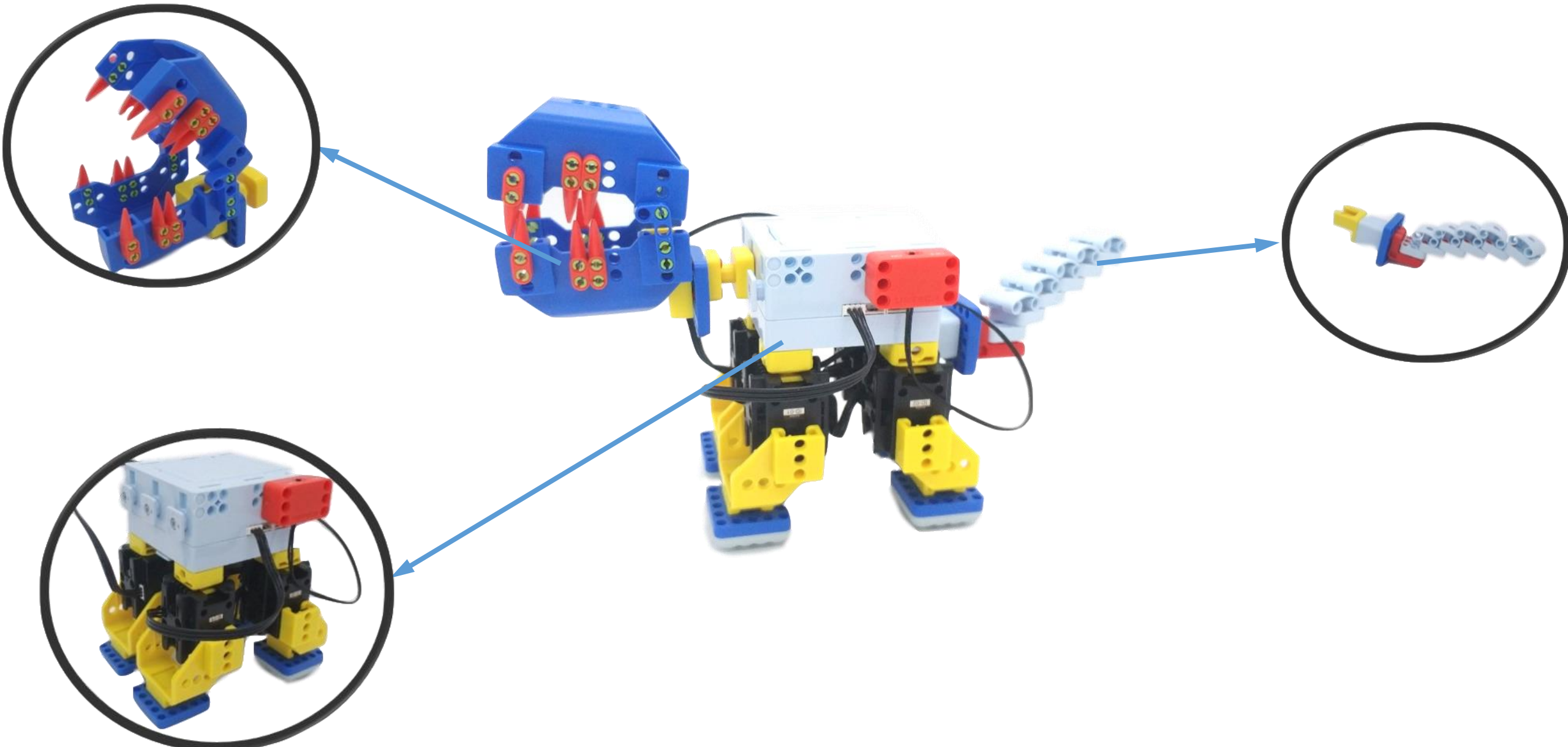



The model consists of 3 parts, as shown below:



Head



Body



Tail



# Head building process

# Head -1

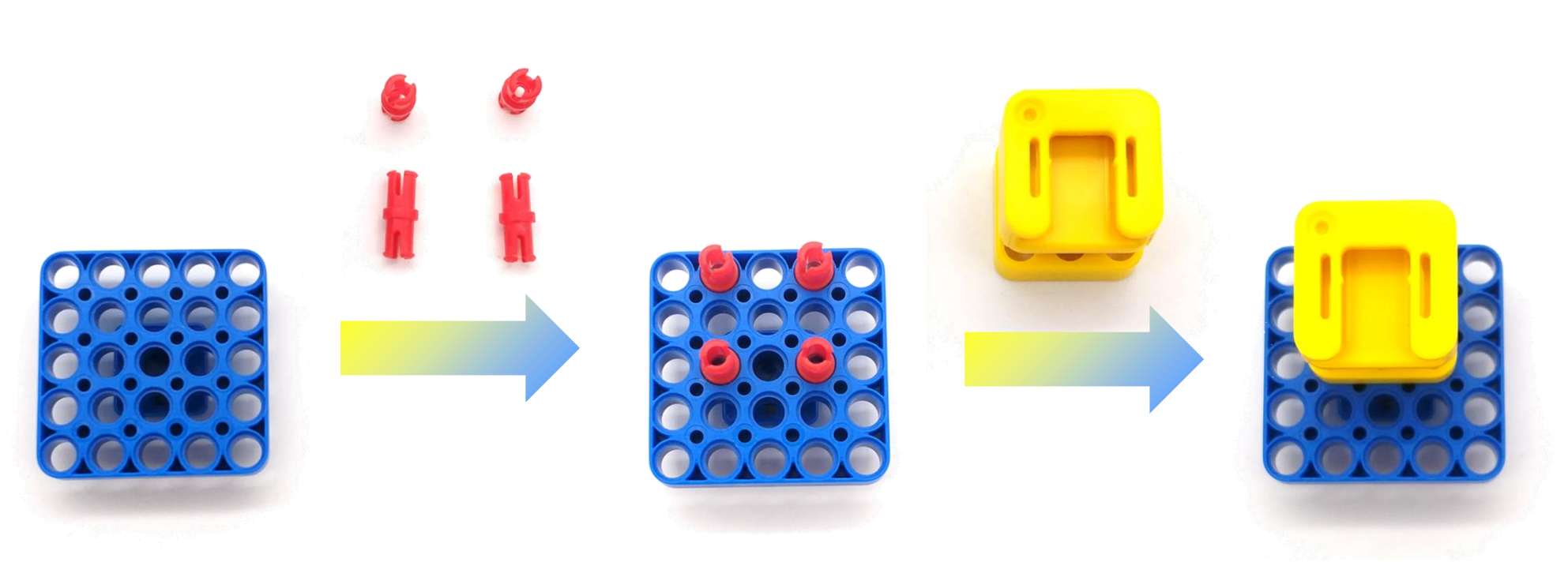



## Head -2

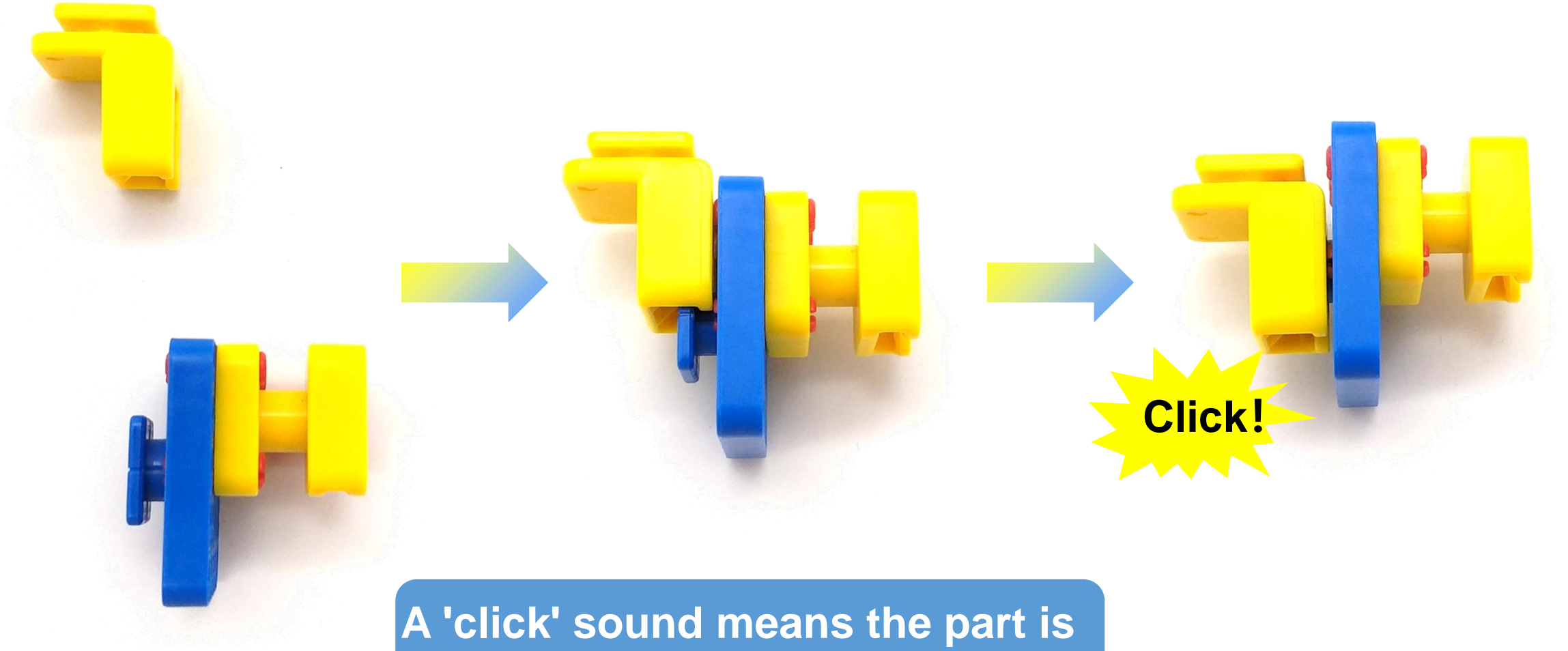

A 'click' sound means the part is locked.

# Head -3

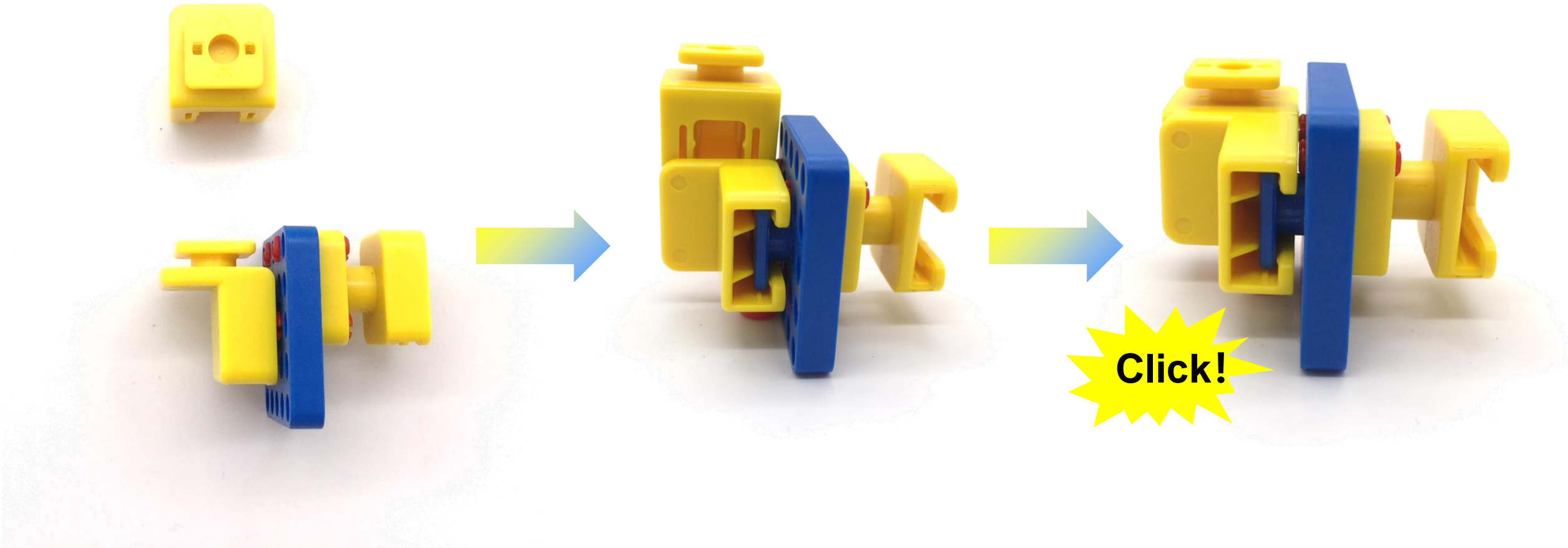

# Head -4

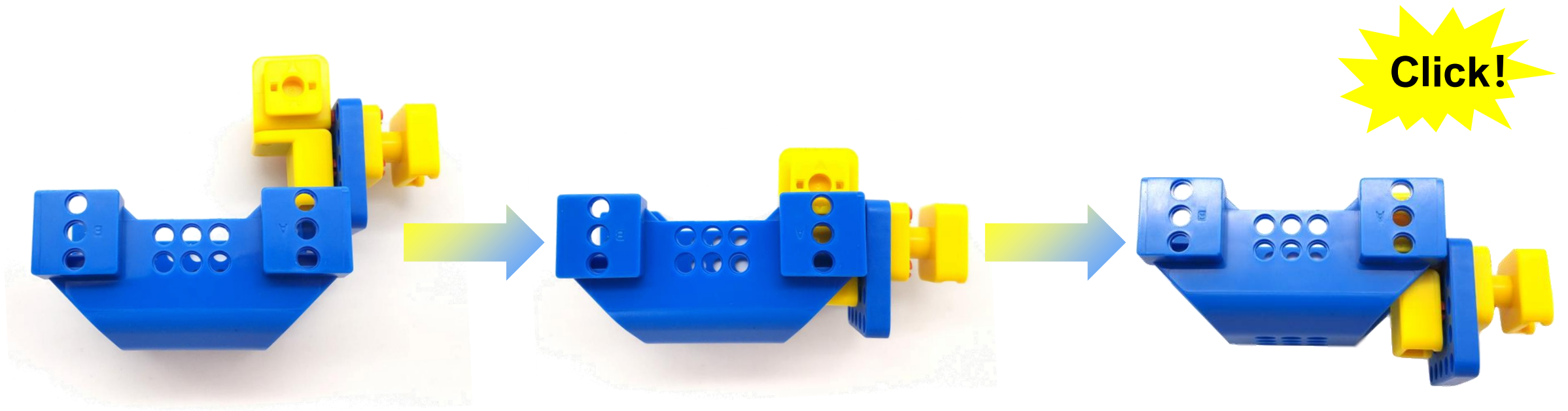

## Head -5

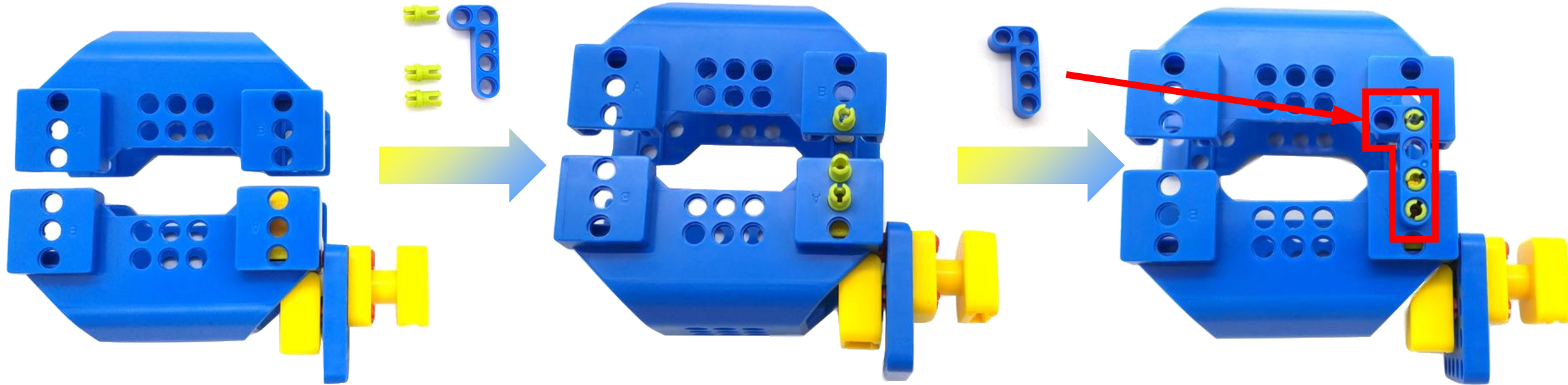

Insert the short end of the green pin into the servo motor clamp and use the same method to set up the other side.

Head -6

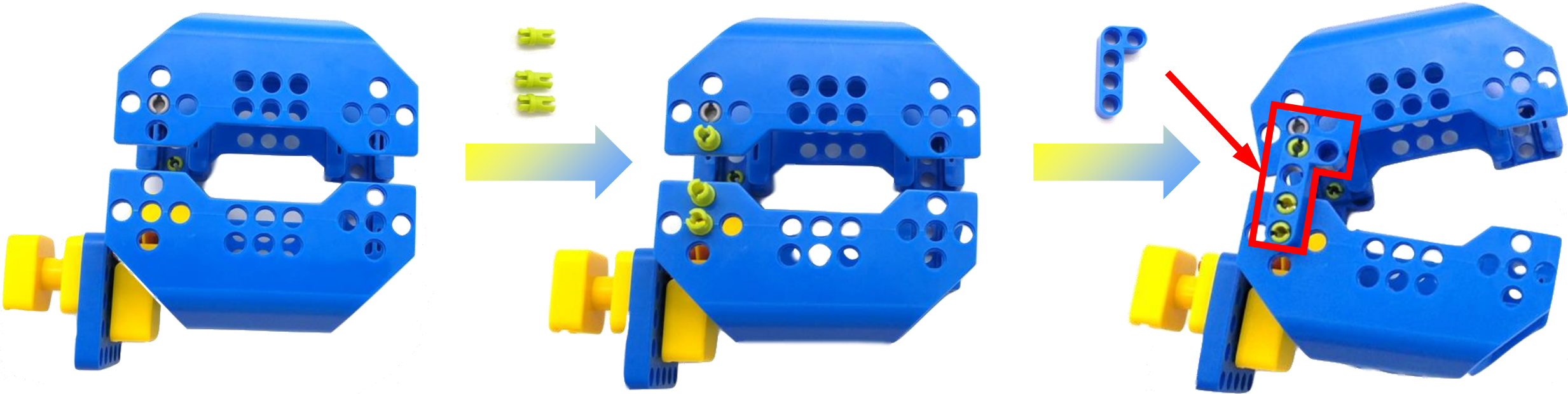



# Head -7

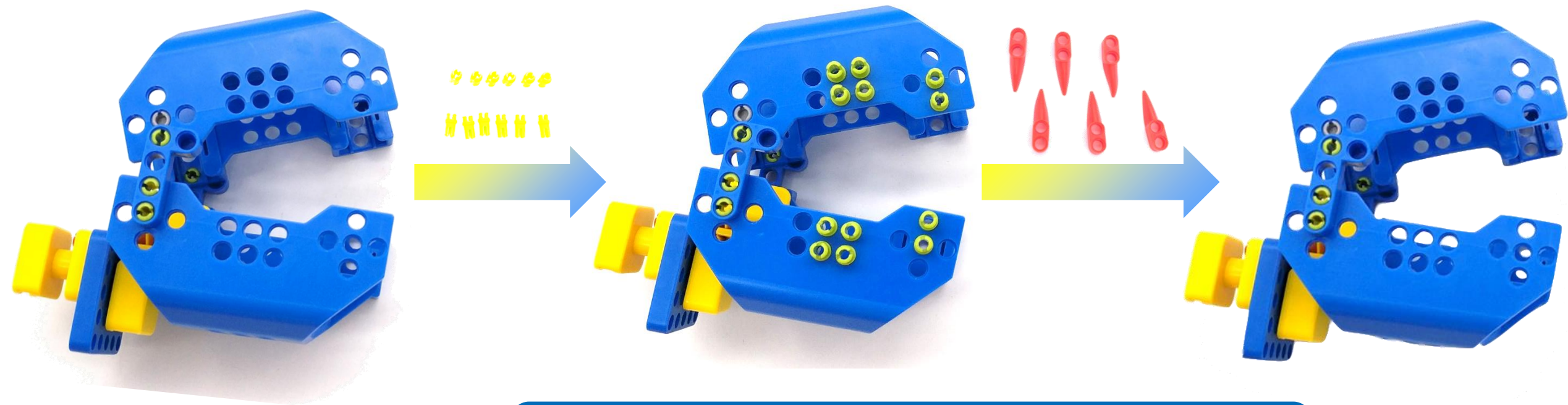

Use the same method to set up the other side

# Head -8

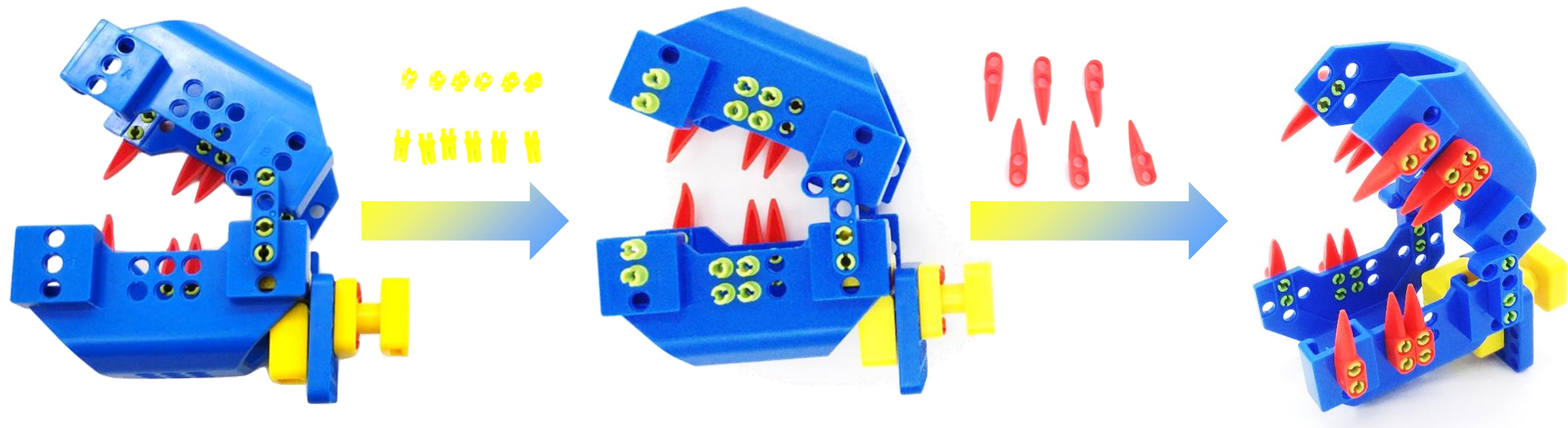

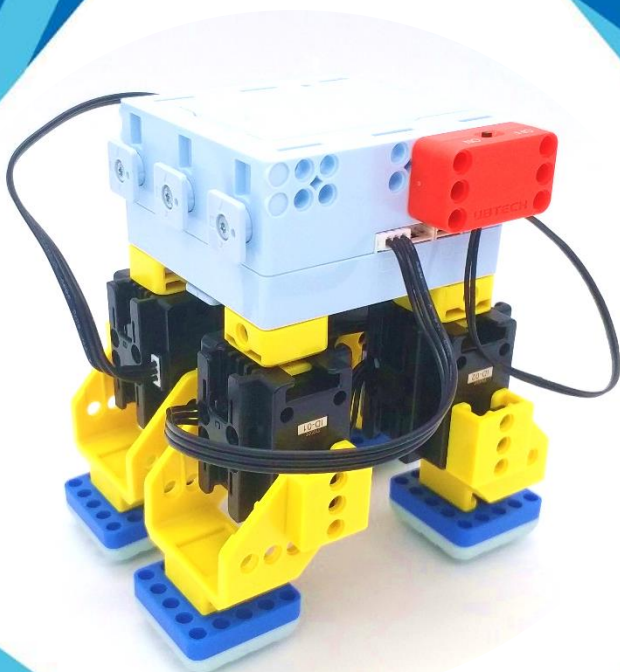

# Body building process

# Body -1

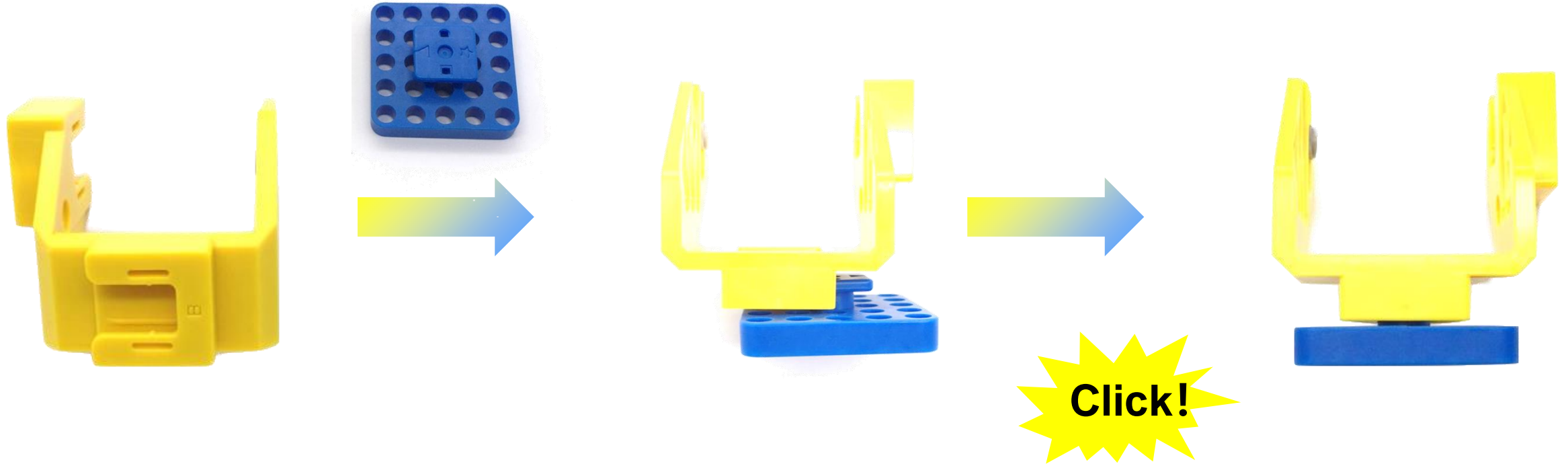

## Body -2

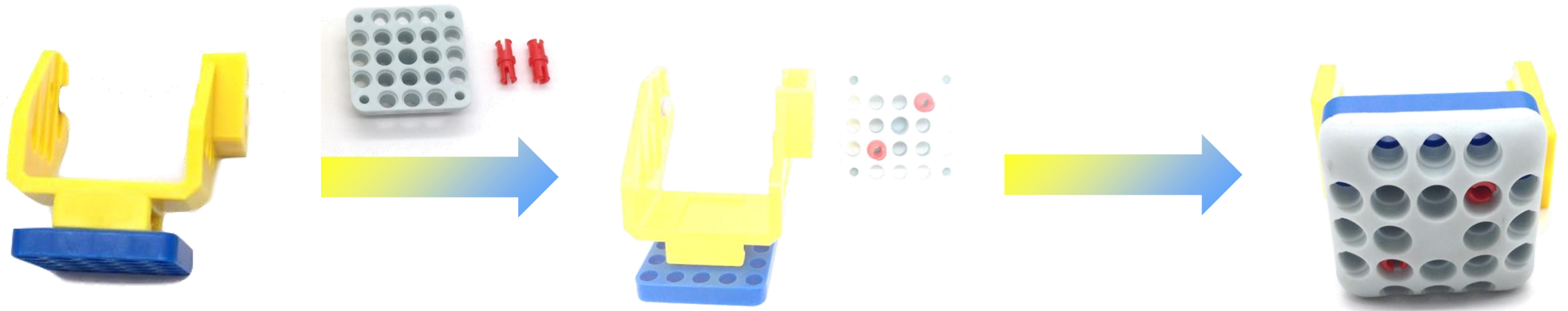



## Body -3

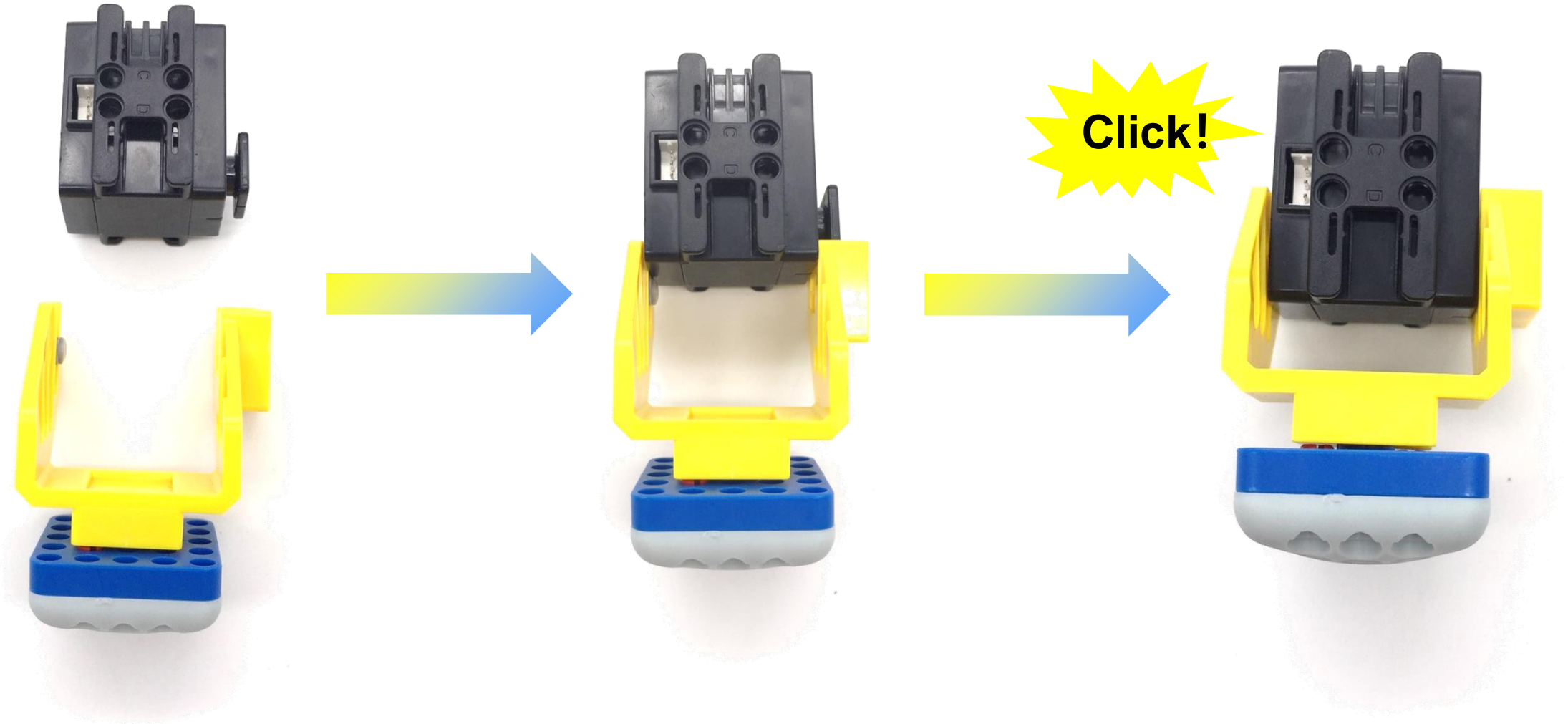

## Body -4

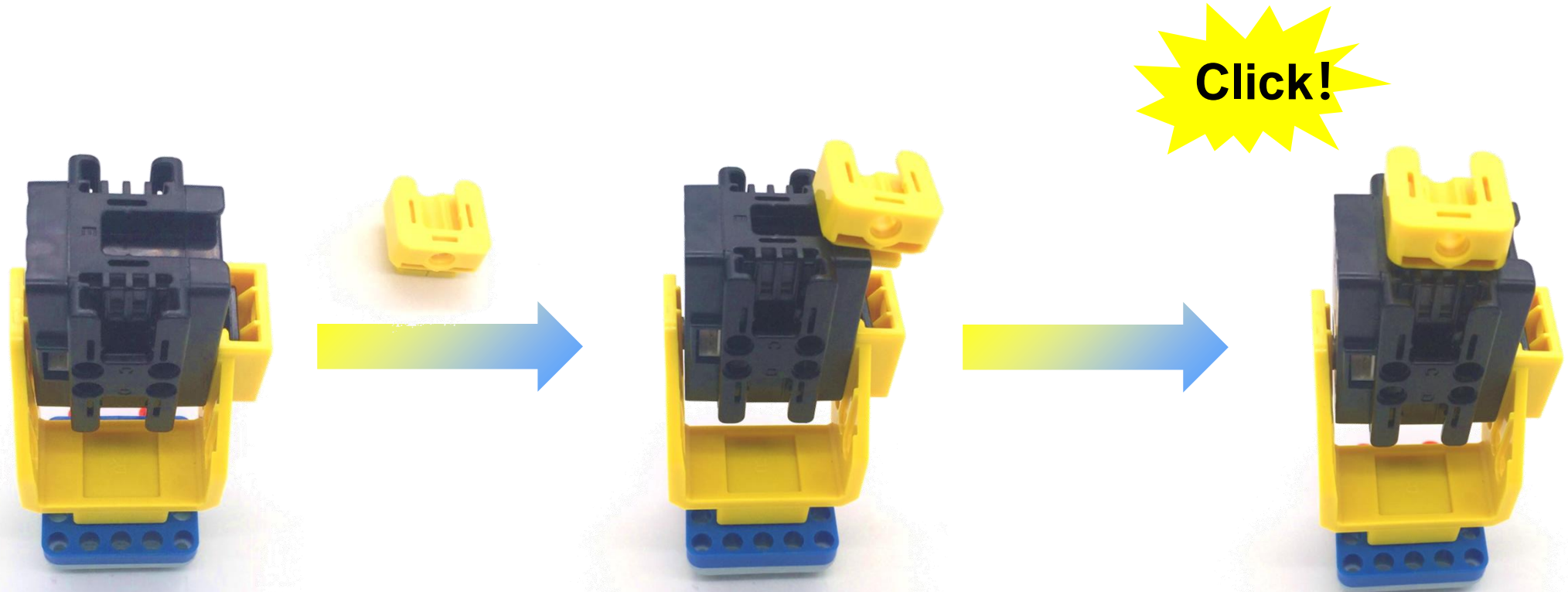

Use the same method to set up the remaining 3 feet!

## Body -5



**Pins and sockets must be one-to-one  
to connect**

# Body -6

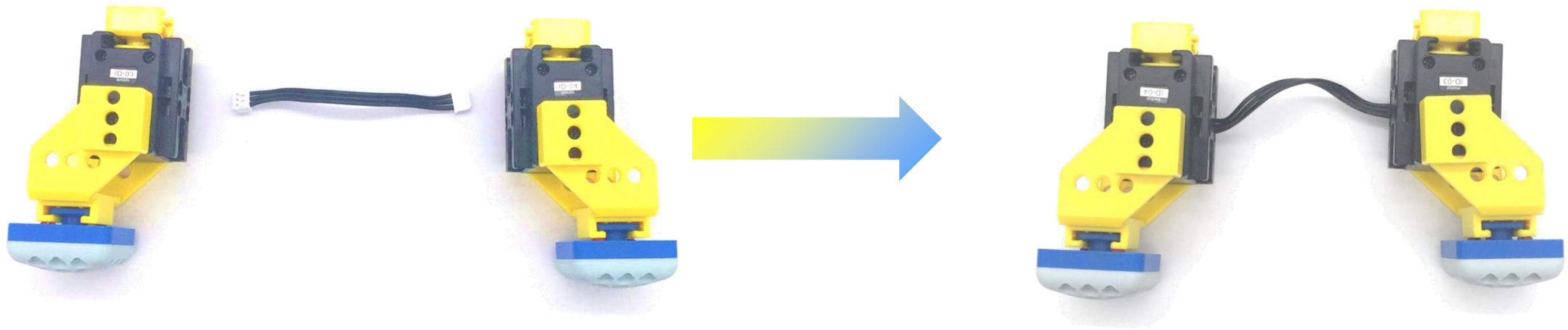

**ID-01 servo is connected to ID-02 servo  
ID-03 servo is connected to ID-04 servo**

# Body -7



ID-03 servo and ID-04 servo



# Body -8

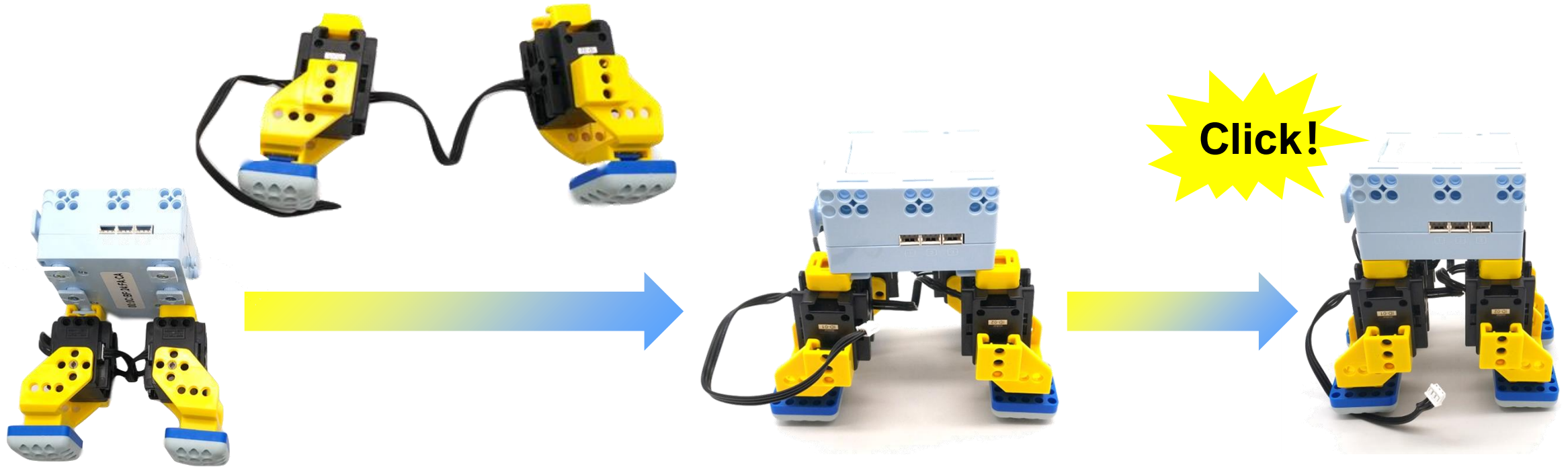

ID-01 servo and ID-02 servo

# Body -9

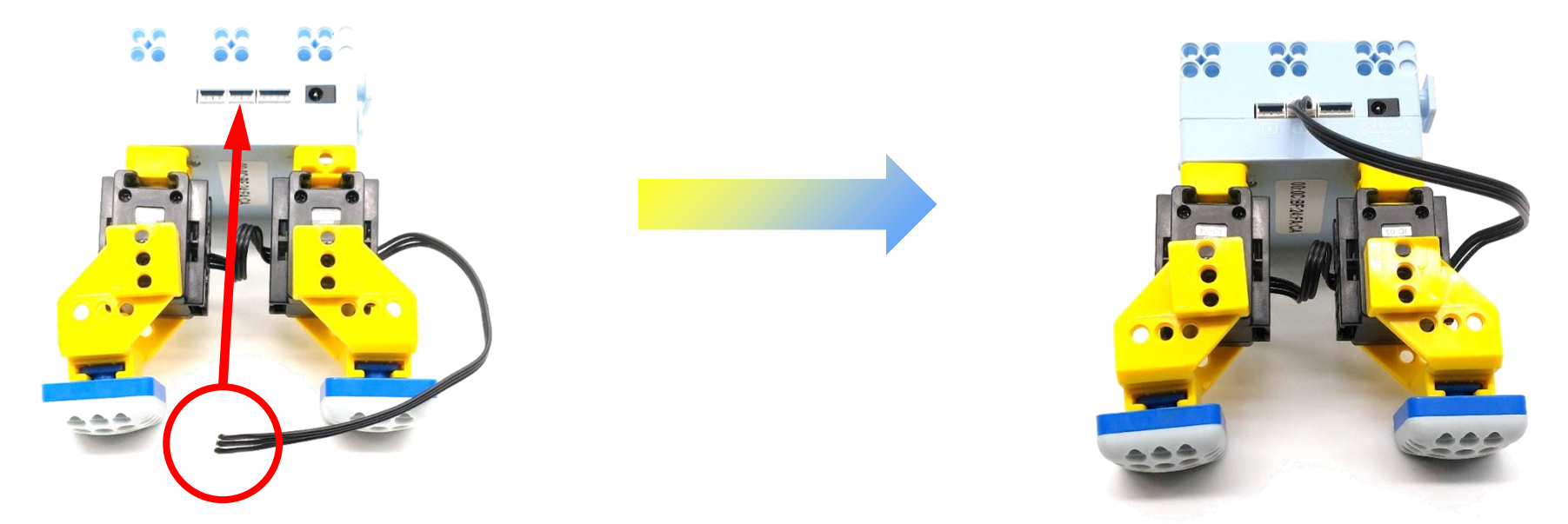

# Body -10

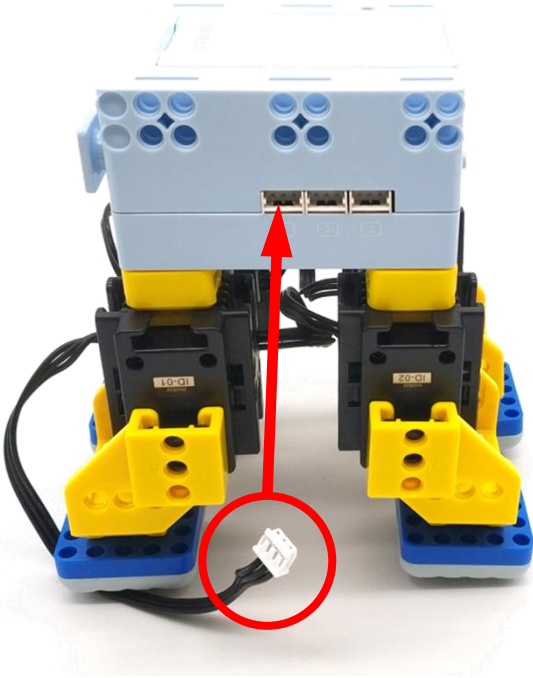

# Body -11

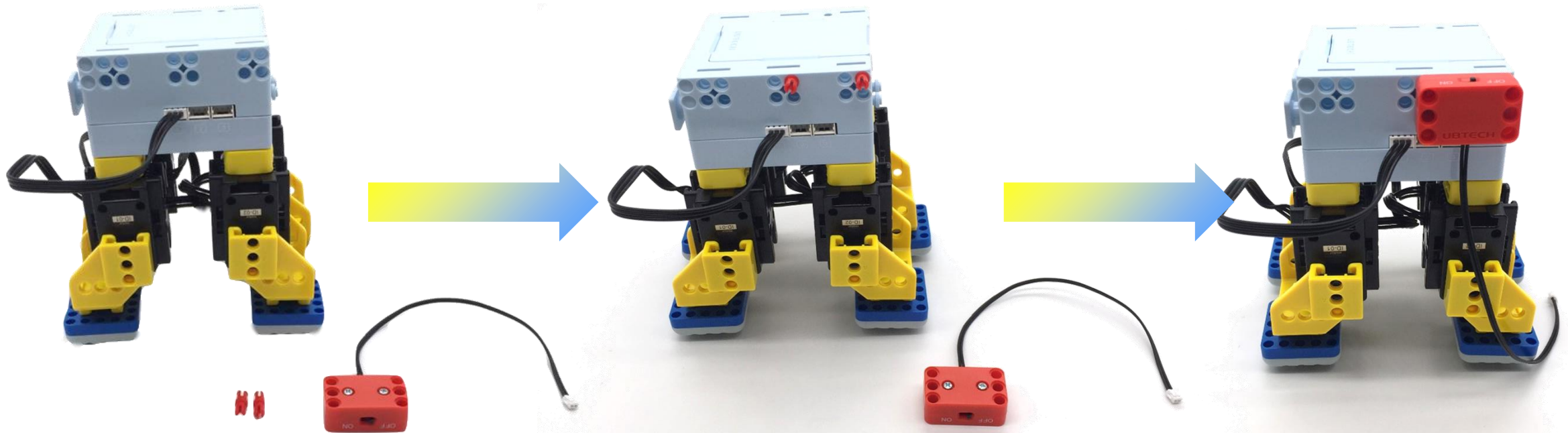

## Body -12

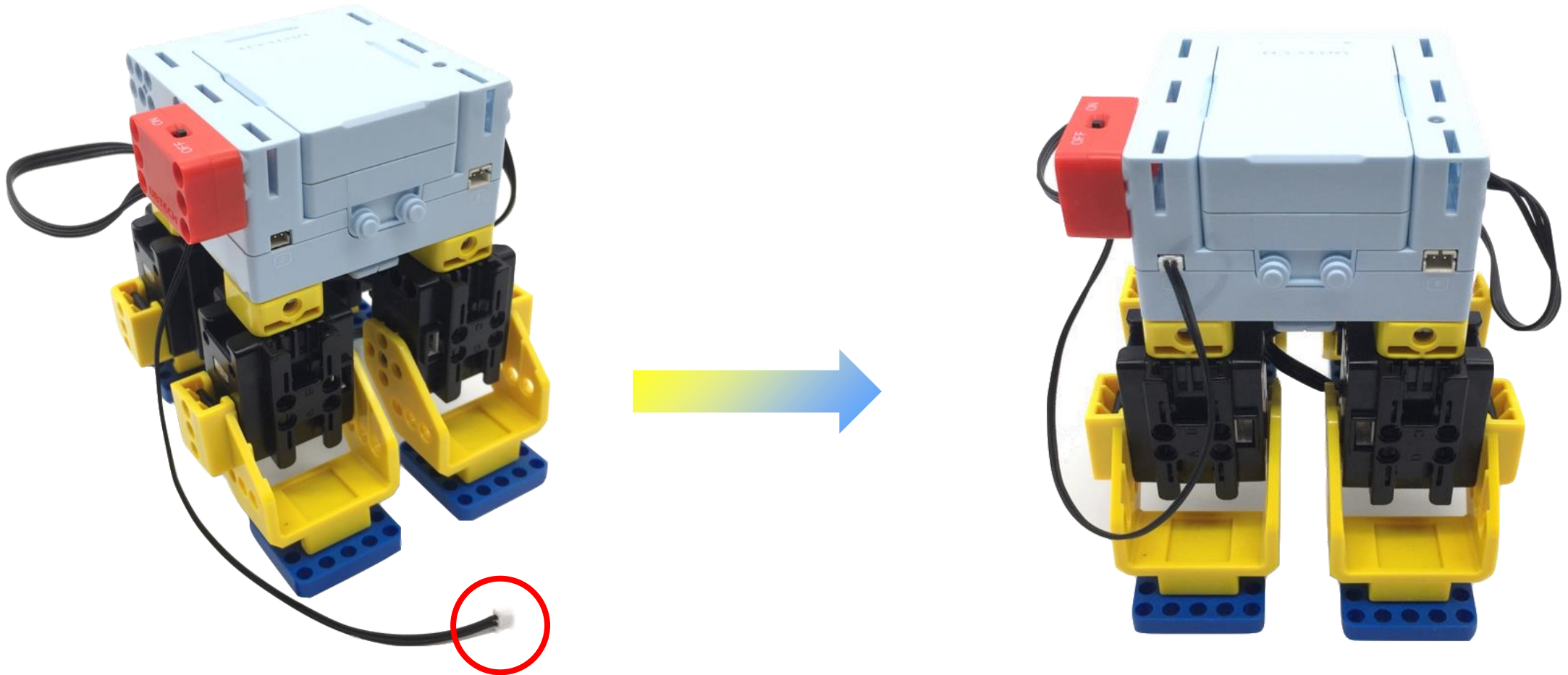

**Connect the switch cable to port 7.**



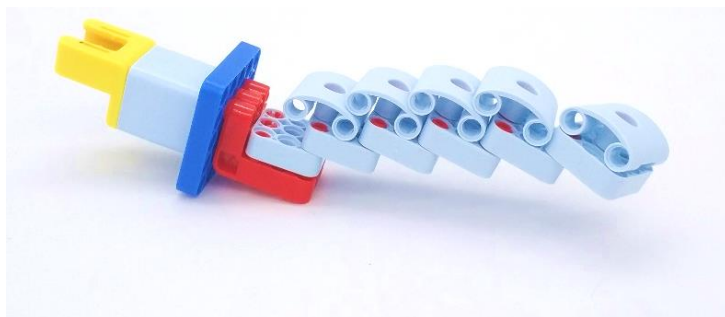

# Tail building process

# Tail -1

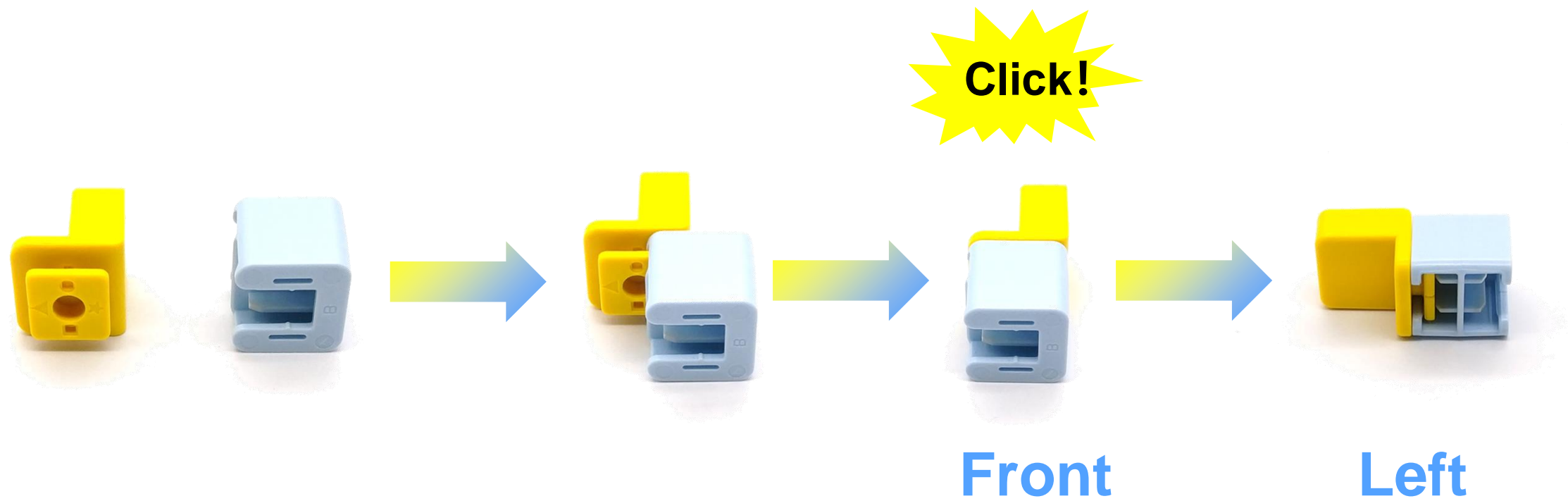

## Tail -2



# Tail -3

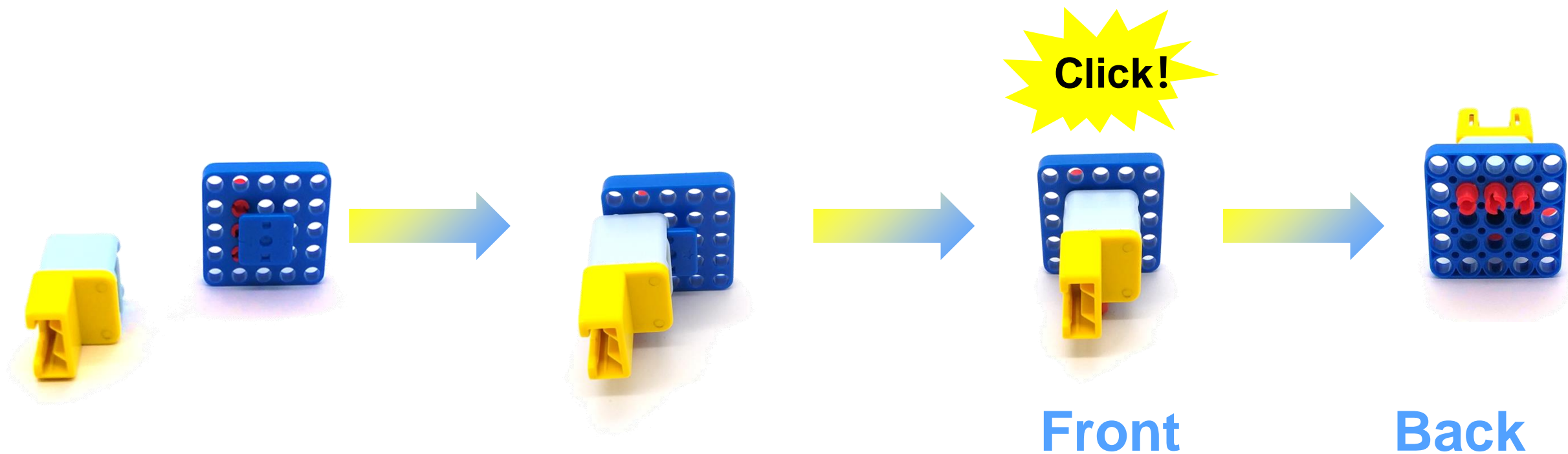

# Tail -4

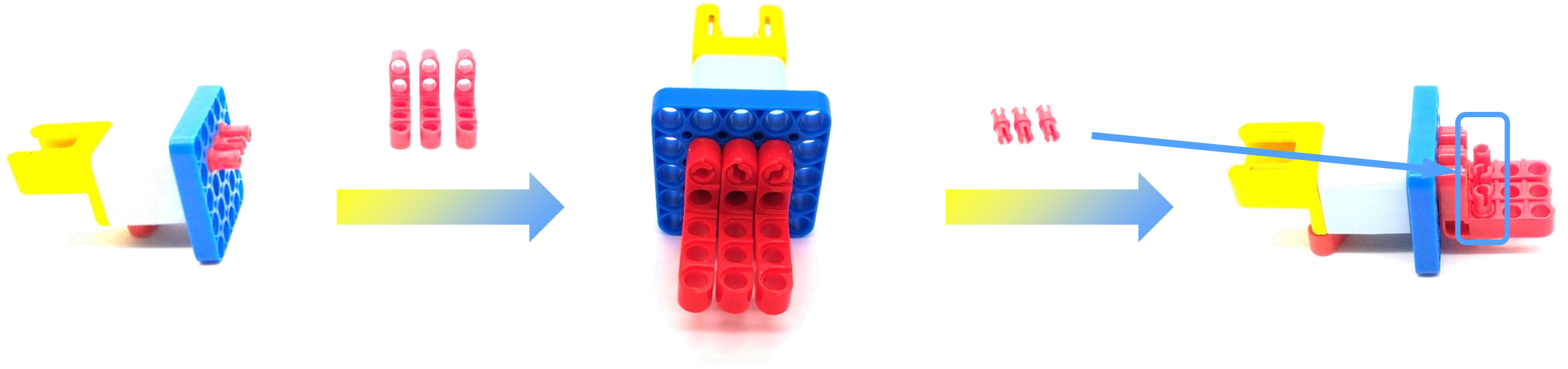



# Tail -5

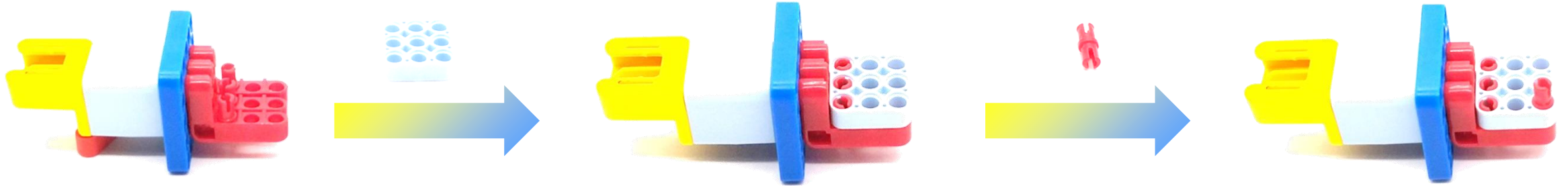

# Tail -6

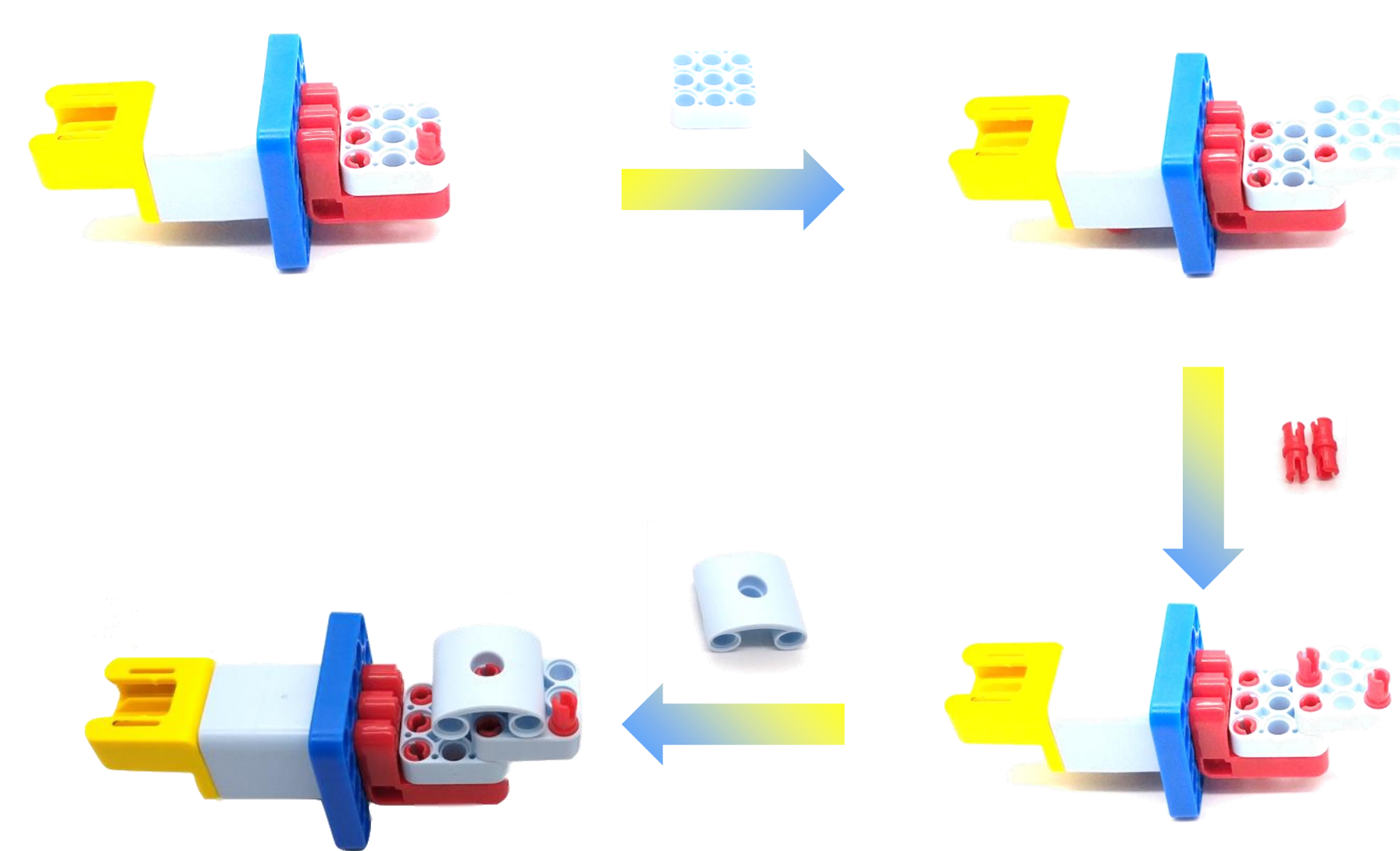

# Tail -7

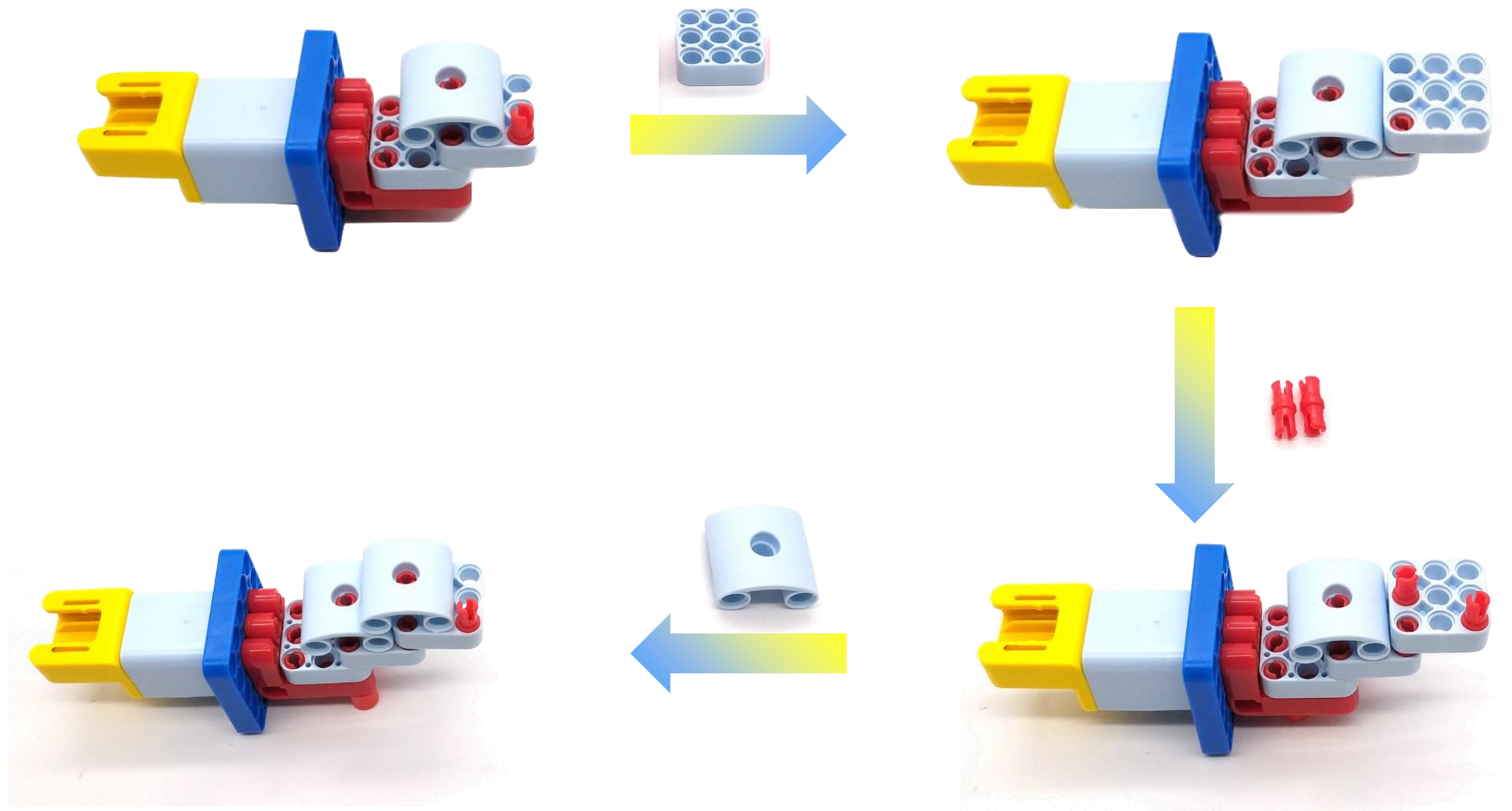

# Tail -8

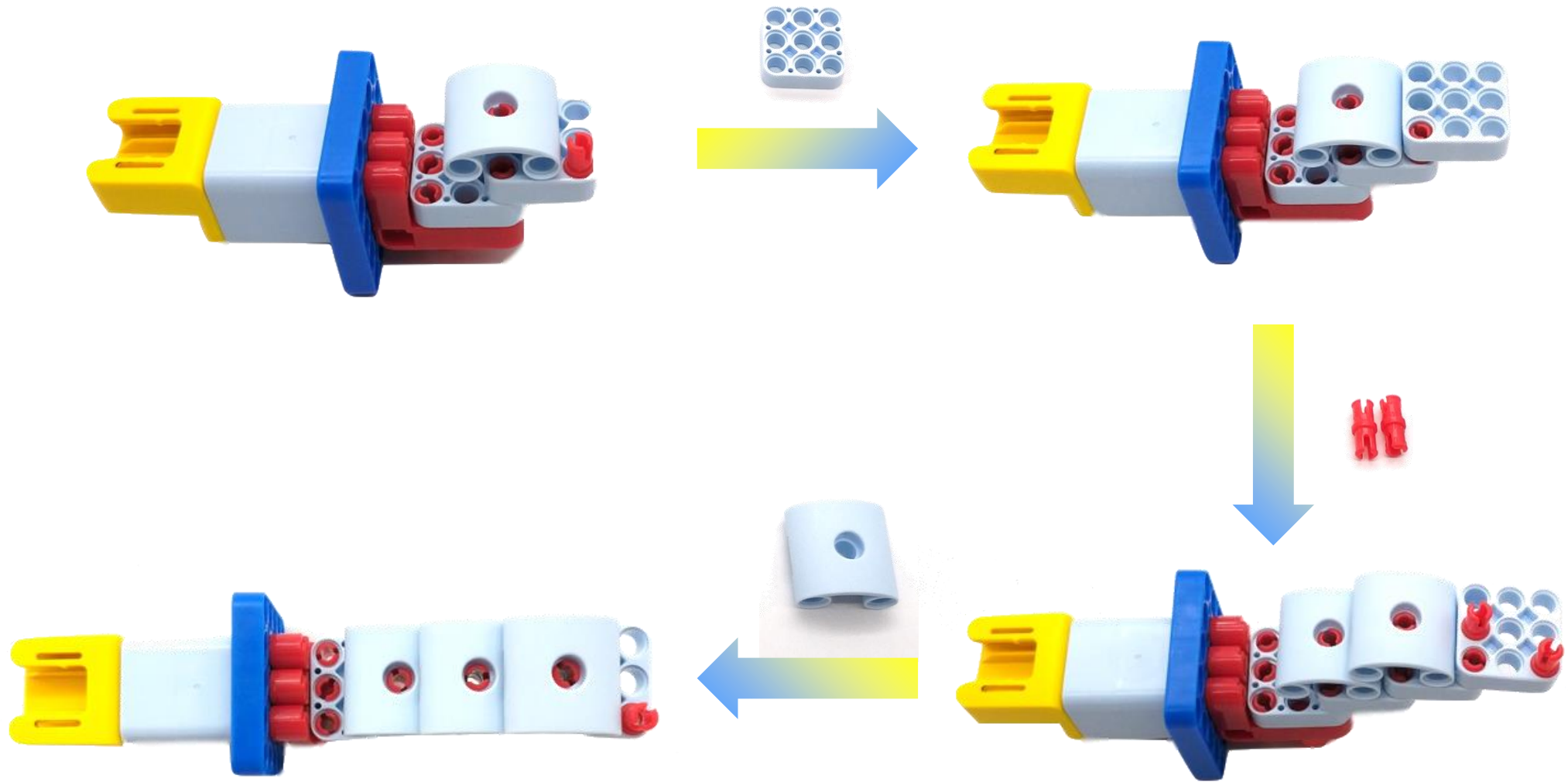

# Tail -9

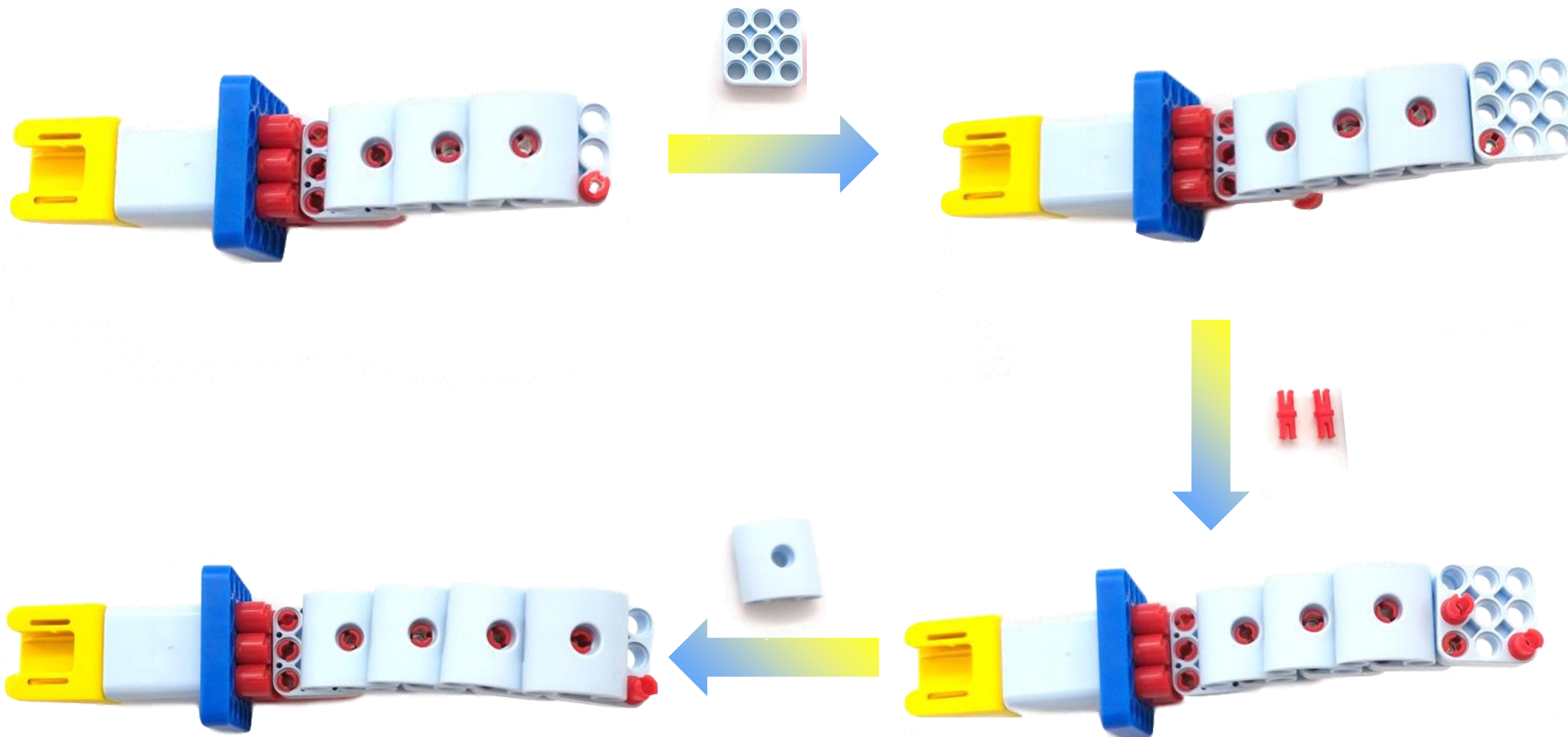



# Tail -10

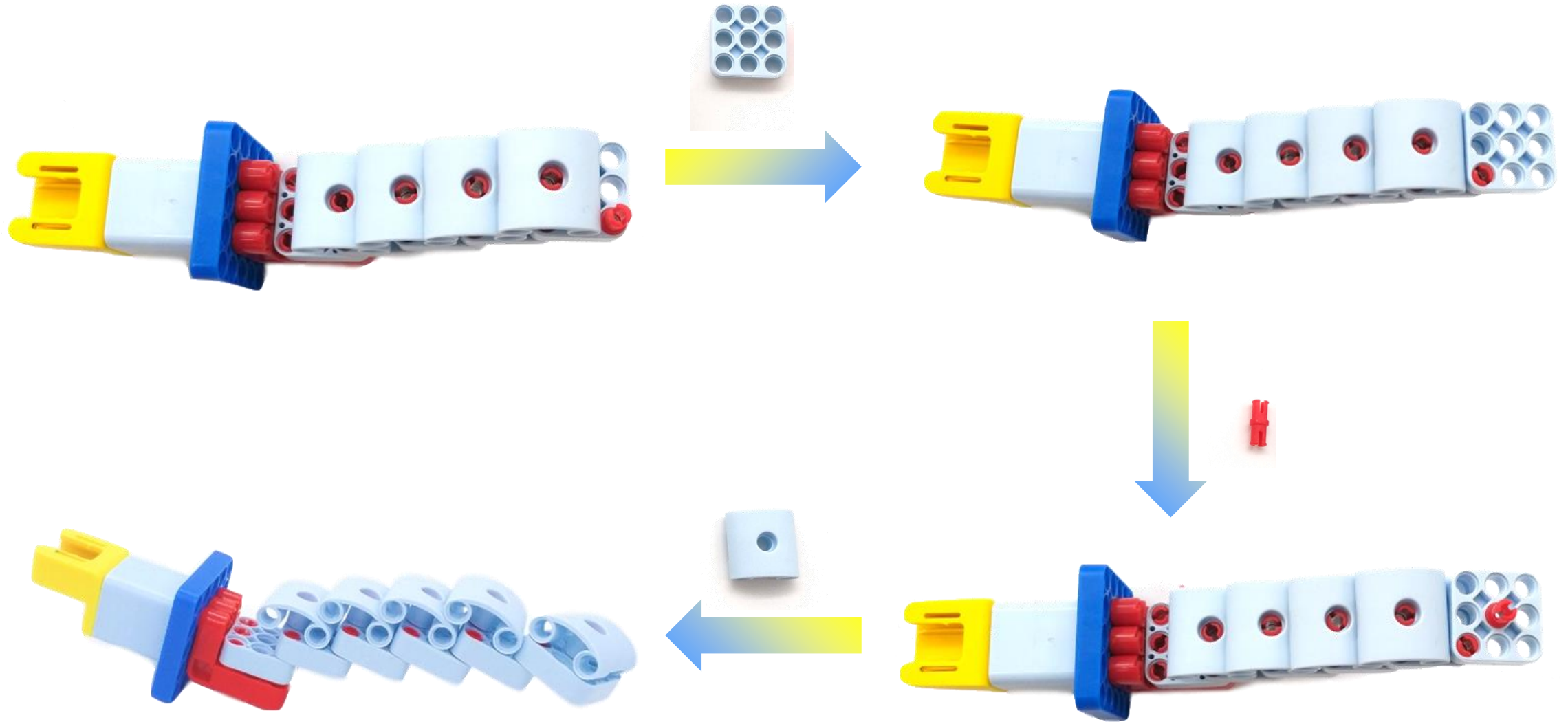

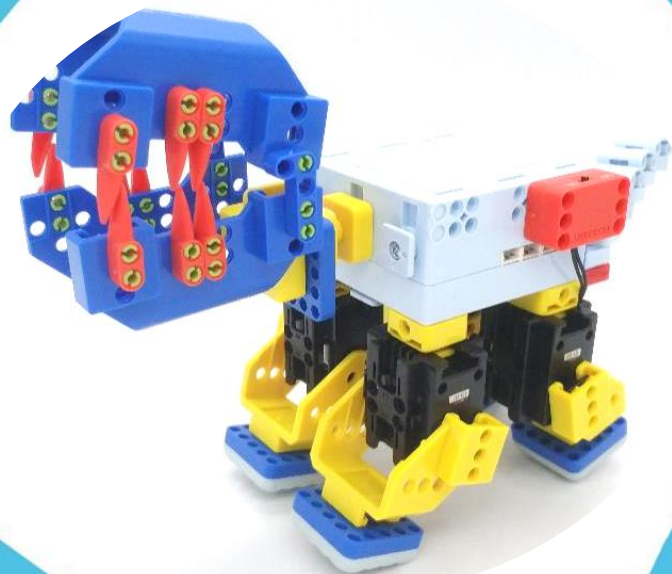

# Assembly!

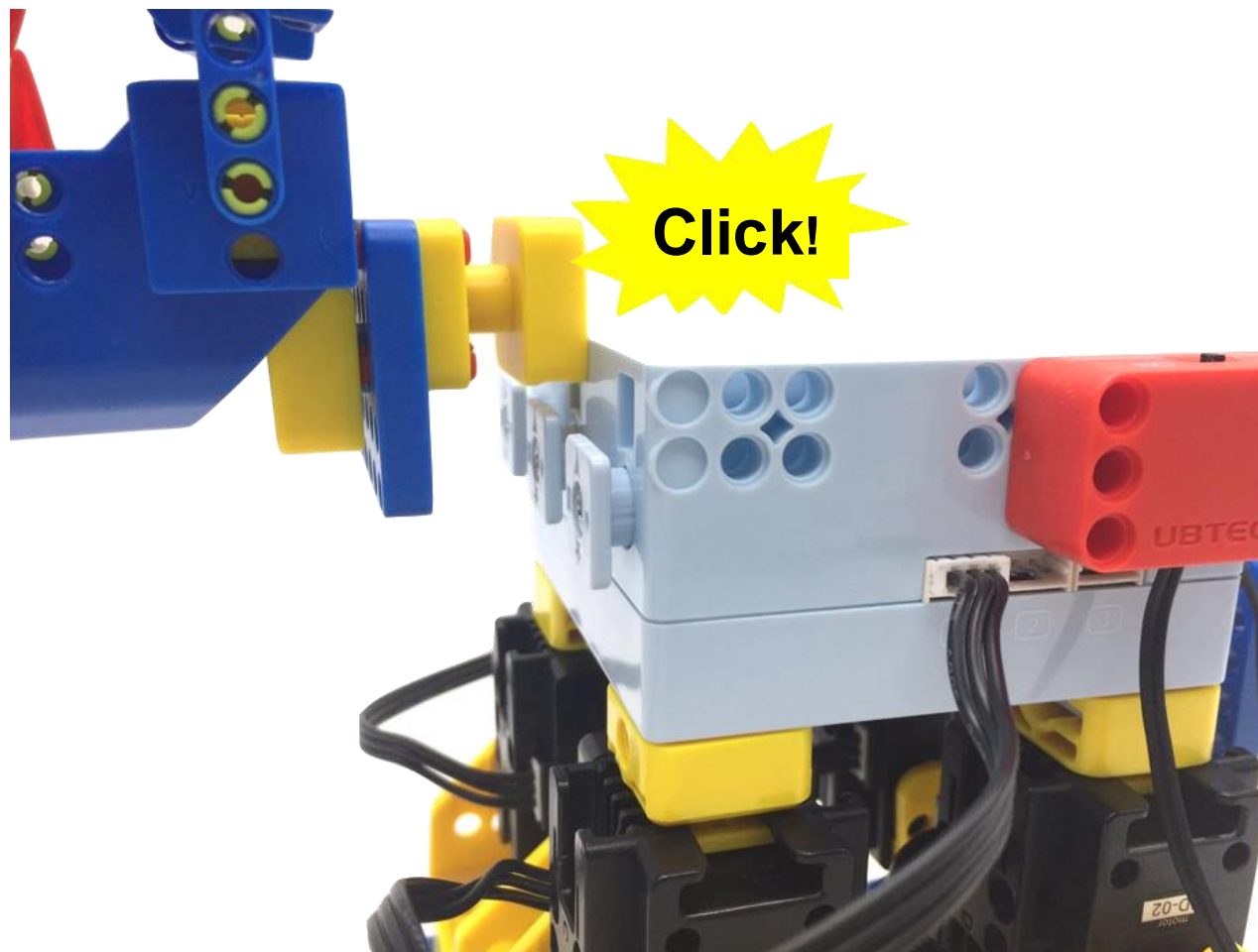

Head and body

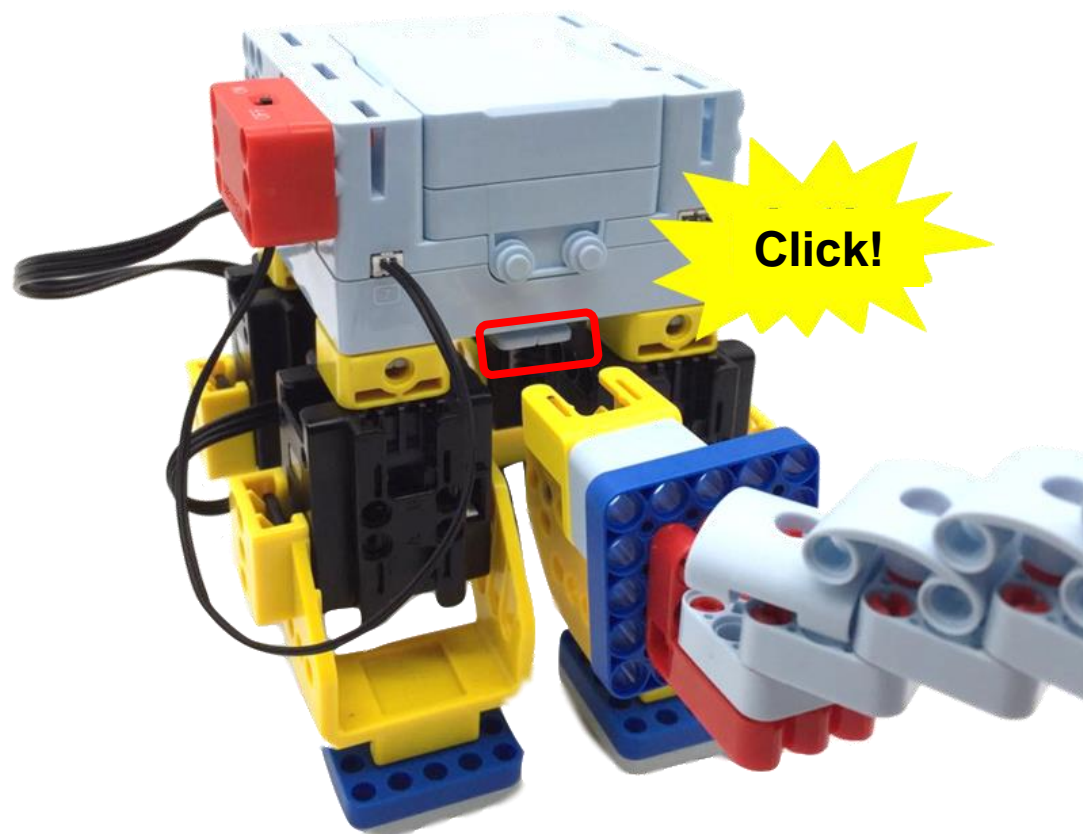

Tail and body

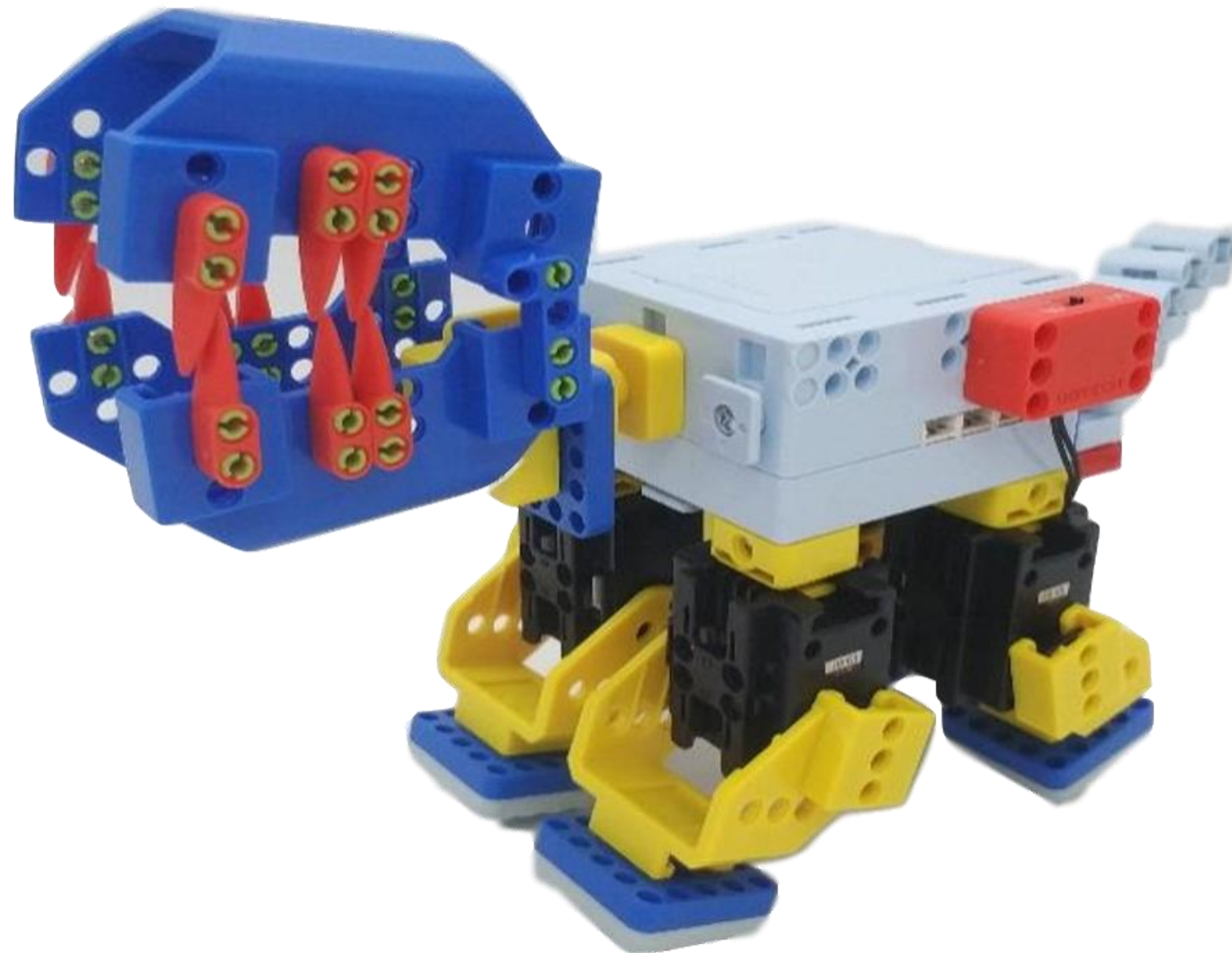

Good job!